

Monteringsanvisning  
Montageanleitung

Assembly instruction  
Instructions de montage

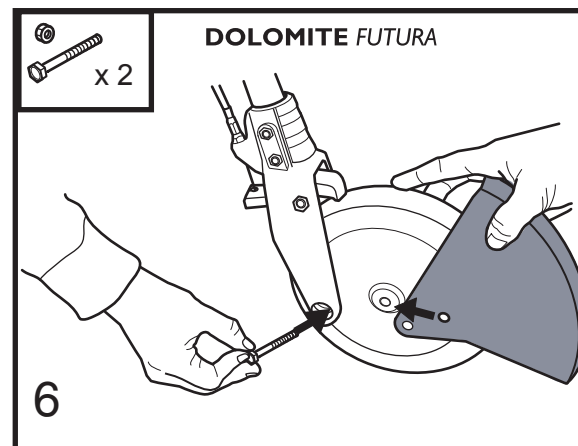
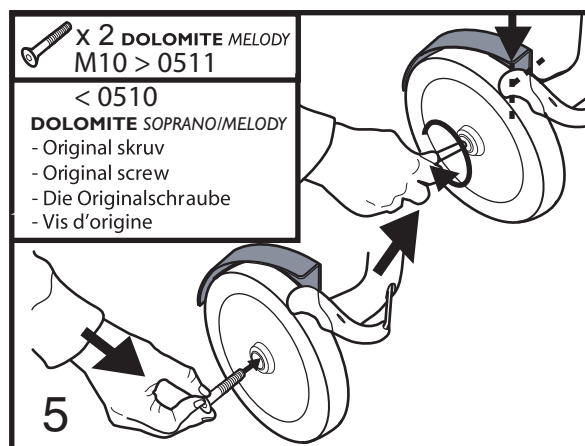
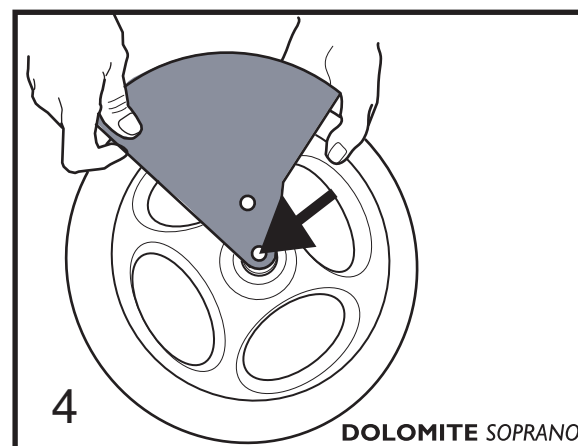
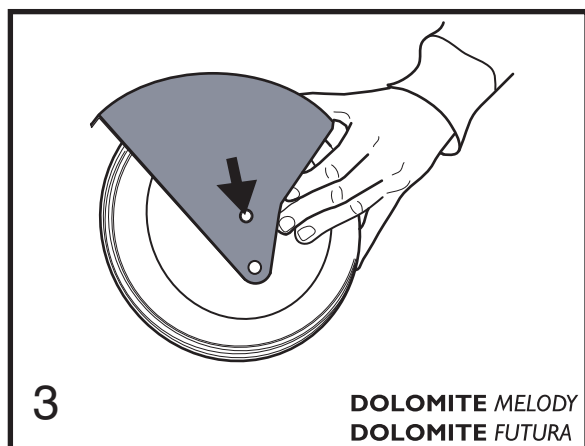
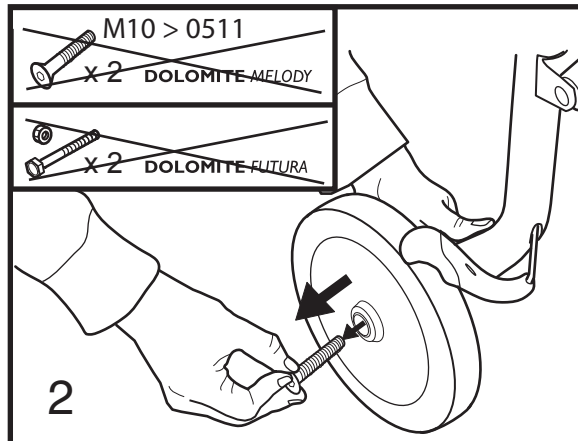
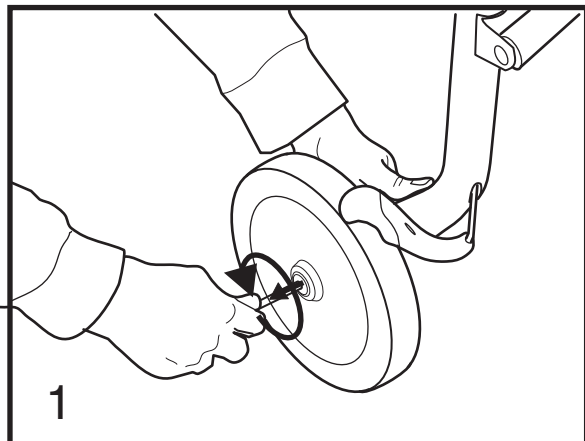

Art no 82067 0605:3

**SV** Vid demontering av hjulskyddet monteras originalskruven tillbaks igen.

**GB** When disassembling the wheel guard, the original screw must be used again.

**DE** Bei Demontage des Radschutzes muss die Originalschraube weiterverwendet werden.

**FR** Lors du démontage de la protection de roue, la vis d'origine doit être remise à sa place.

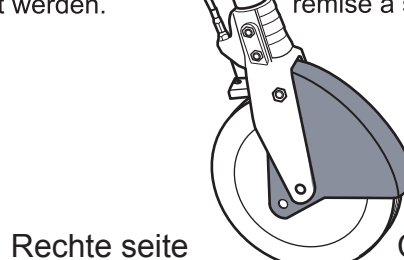
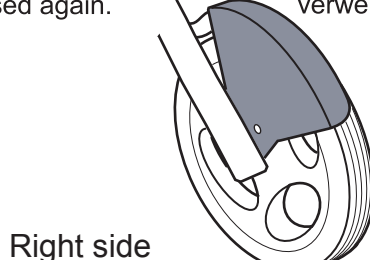
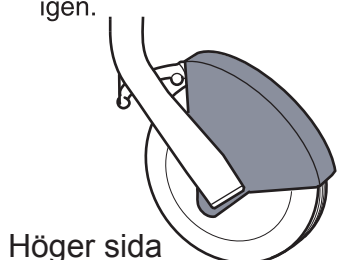

Côté droit